

DESCRIPTION

The DREW Gravity Metering System is a graduated tank and a flow control meter unit that can be used for continuous dosing of liquids to locations with pressures that are low or at vacuum.

MARINE APPLICATIONS

Evaporator Treatment Program

- AMEROYAL® evaporator treatment
- AMEROYAL CF concentrated evaporator treatment
- AMEROYAL CF/HG concentrated evaporator treatment

PERFORMANCE SPECIFICATIONS

Flow Control Meter Range: 20-200 cc/min (ml/min)
Tube Length: 10 mtr (32 ft)
Tank Capacity: 60 ltr (16 gal)

DREW GRAVITY METERING SYSTEM INSTALLATION

The system should be installed in a convenient spot with the tank fitted higher than the dosing point. The flow meter should be located in an easy-to-reach location and must be mounted in a vertical position. The flow meter and isolation valve should be mounted so that the entire assembly is rigid and not subject to movement during routine treatment dosing adjustments. It is important to ensure that the connections between the tank and the dosing location are vacuum-tight. Using the flow control meter valve as a stop valve is not recommended.



DREW Gravity Metering System (PCN 1AA8977)



Contact your Drew Marine representative for more information

Drew Gravity Metering System
PCN 1AA8977

#	PCN	Description	Qty
10	107012	Flow Meter, 0 - 200 cc/min	1
20	1AA9003	Drew Dosing Tank, 60 ltr, PE	1
21	*1(AA9003)	Bulkhead Fitting, 1/2" 316 SS	1
22	*1(AA9003)	Reducer, 1/2" MNPT x 1/2" FNPT	1
23	*	Nipple, 1/2" MNPT x Close, 316SS	1
40	*	Ball Valve, 1/2" TXT, 316 SS, PTFE	1
50	*	Connector, 1/2" MNPT x 1/2" Tube, 316 SS	2
60	*	Connector, 1/2" MNPT x 1/2" Tube, 316 SS	1
70	1AA9002	Fitting Kit, 1/2" Tubing	1
71	*1(AA9002)	Tubing, 1/2" OD, PE	10 mtr
72	*1(AA9002)	Ball Valve, 1/2" TXT, 316 SS, PTFE	1
73	*1(AA9002)	Connector, 1/2" MNPT x 1/2" Tube, 316 SS	1

PCN - When ordering spares, specify the PCN. * - Indicates the spare part is not supplied separately. * () - Indicates the spare part is included with the PCN indicated.

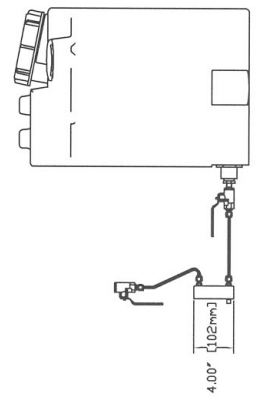
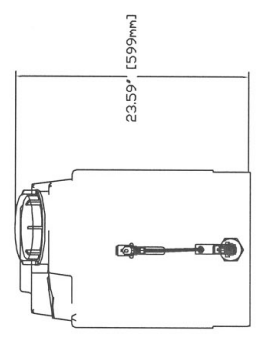
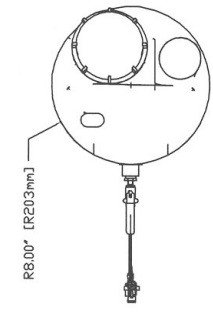
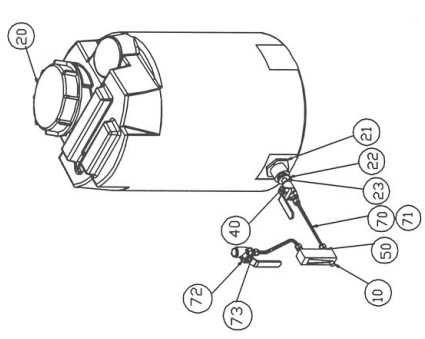

Ashtand assumes no responsibility for the design or operation of any equipment or material shown on this drawing not supplied by Ashtand. This print is issued subject to return upon demand and upon the express condition that it is not to be used directly or indirectly in any way detrimental to Ashtand's interest. © 2008, Ashtand

	DREW GRAVITY METERING SYSTEM	Notes
PCN 1AA8977	DWC# *.DM-7745831-200	

▶ **Contact your Drew Marine representative for more information**

Drew Marine maintains Safety Data Sheets on all of its products. These documents contain health and safety information for the development of appropriate product handling procedures to protect your employees. Safety Data Sheets should be read and understood by all of your supervisory personnel and employees before using Drew Marine products.



Drew Marine®

**100 South Jefferson Road
Whippany, NJ 07981 USA
1-973-526-5700
Drew-Marine.com**

Copyright © Drew Marine. All Rights Reserved. All statements, information and data presented herein are believed to be accurate and reliable but are not to be taken as a guarantee, express warranty or implied warranty of merchantability or fitness for a particular purpose, or representation, express or implied, for which seller assumes legal responsibility, and they are offered solely for your consideration, investigation and verification. Statements or suggestions concerning possible use of this product are made without representation or warranty that any such use is free of patent infringement and are not recommendations to infringe on any patent.